

| Ratio Options   1 |
|-------------------|
| 1PD06             |
| 1.67 Dec.         |
| 1.57 Dec.         |
| 1.48 Dec.         |
| 1.40 Dec.         |
| 1.32 Dec.         |
| 1.25 Dec.         |
| 1.18 Dec.         |
| 1.06 Dec.         |
| 1:1               |
| 1.06 Inc.         |
| 1.18 Inc.         |
| 1.25 Inc.         |
| 1.32 Inc.         |
| 1.40 Inc.         |
| 1.48 Inc.         |
| 1.57 Inc.         |
| 1.67 Inc.         |

| Input Shaft Options   2 |        |
|-------------------------|--------|
| Shaft Description       | Dim. F |
| 1810 Companion          | 2.62   |
| 1610 Companion          | 2.62   |
| 2-1/2 Dia. Keved        | 3.25   |
| 2-1/4 Dia. Keved        | 3.25   |
| 29T-12/24               | 3.80   |
| 20T-10/20               | 3.80   |
| 15T-8/16                | 3.80   |
| 1550 Companion          | 2.62   |

| SAE Pump Pad Adapters   3 |                  |             |            |        |
|---------------------------|------------------|-------------|------------|--------|
| SAE Size                  | Bolt Size & Qty. | Bolt Circle | Pilot Dia. | Dim. H |
| A                         | 3/8-16 (2)       | 4.187       | 3.25       | 7.63   |
| B                         | 1/2-13 (2)       | 5.750       | 4.00       | 7.63   |
| B                         | 1/2-13 (4)       | 5.000       | 4.00       | 7.63   |
| C                         | 5/8-11 (2)       | 7.125       | 5.00       | 7.63   |
| C                         | 1/2-13 (4)       | 6.375       | 5.00       | 7.63   |
| D                         | 3/4-10 (4)       | 9.000       | 6.00       | 7.63   |
| D2                        | 3/4-10 (2)       | 9.000       | 6.00       | 7.75   |
| E                         | 3/4-10 (4)       | 12.500      | 6.50       | 7.75   |
| F                         | 1.00-8 (4)       | 13.781      | 7.00       | 8.13   |

| SAE Pump Spline Adapters   4 |               |
|------------------------------|---------------|
| SAE Size                     | Teeth & Pitch |
| A                            | 9T-16/32      |
| B                            | 13T-16/32     |
| BB                           | 15T-16/32     |
| C                            | 14T-12/24     |
| CC                           | 17T-12/24     |
| D                            | 13T-8/16      |
| F                            | 15T-8/16      |
| 21                           | 21T-16/32     |
| 23                           | 23T-16/32     |
| 27                           | 27T-16/32     |

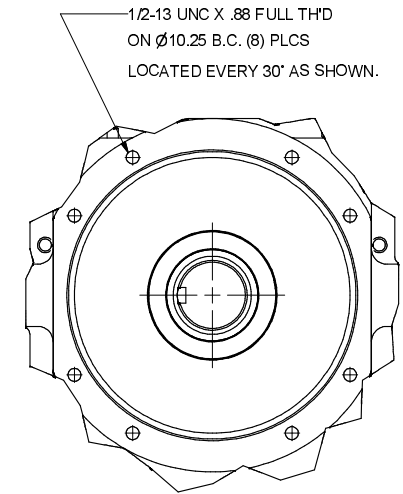
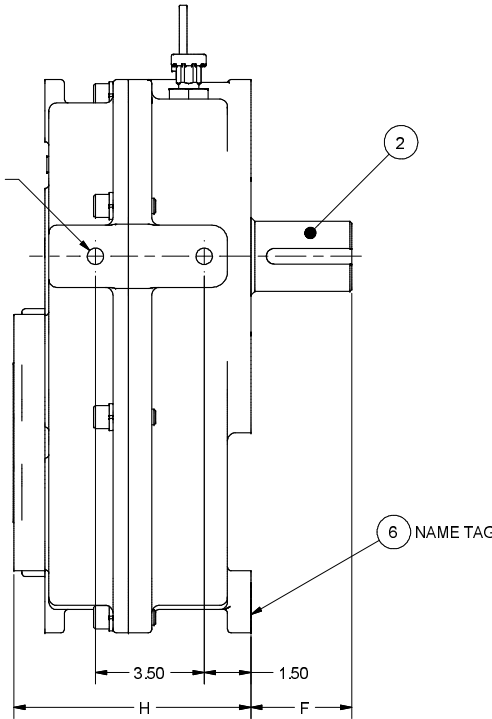
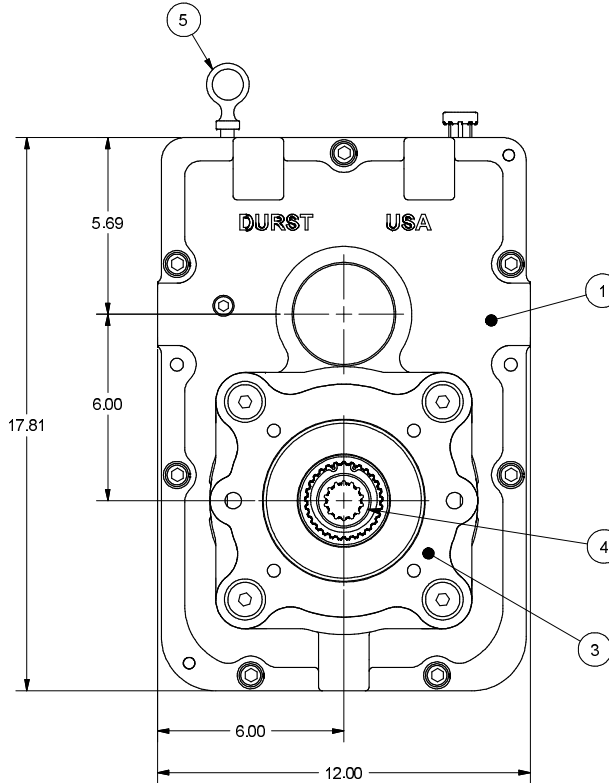

MOUNTING RING

NOTE:

- REFER TO ASSEMBLY BOOK FOR ADAPTER MOD DRAWINGS.
- LUBRICATE ALL ORINGS PRIOR TO INSTALLATION.
- APPLY SILVER STREAK #200S TO EXTERNAL SPLINES OF INPUT SHAFT.
- USE LOCTITE 609 WHEN INSTALLING EXP. PLUG, P/N 012043.
- USE LOCTITE 609 WHEN INSTALLING DIPSTICK, AND DIPSTICK HOLE PLUG, P/N 012326.
- DO NOT USE LOCTITE ON PUMP PAD SCREWS.
- TIGHTEN 1/2" SCREWS: 105 FT. LBS.
- TIGHTEN 5/8" SCREWS: 210 FT. LBS.
- OIL MUST MEET API GL-5 SPEC: 80W/90, EP90 OR EQUIVALENT.
- WHEN ORDERING PARTS REFER TO THE DURST SERVICE MANUAL.

PATENT NO. 7,152,711

**CAUTION**  
Always insure that your powertrain is free of torsional vibrations. DURST is not responsible for damage or failure due to unaddressed torsional vibrations.

| REV | W/O. NO. | ZONE | DESCRIPTION                                       | BY  | DATE     |
|-----|----------|------|---|-----|----------|
| 0   | 26852    |      | REVISE GEARBOX WIDTH TO LOCATION OF MOUNTING PADS | WEM | 2/2/10   |
| 5   | 27419    |      | ADDED 1.06 RATIOS AND PATENT NO.                  | WEM | 5/22/07  |
| 4   | 25834    |      | UPDATED SPLINE CHART                              | NJS | 11/05/04 |
| 3   | 25741    |      | ADDED 1.25 INC. AND 1.25 DEC. RATIOS              | NJS | 10/01/04 |
| 2   | 25721    |      | UPDATED ITEM NUMBERS                              | NJS | 9/24/04  |
| 1   | 24580    |      | RELEASED TO PRODUCTION                            | NJS | 8/27/04  |

|  |  |   |  |   |  |
|--|--|---|--|---|--|
| ALL DIMENSIONS IN INCHES UNLESS OTHERWISE SPECIFIED. CASTINGS ALLOW .12 FINISH STOCK ON MACHINED SURFACES. RILETS AND RADII: 12 MAX. MACHINING TOLERANCES: X = .02 FRC = .004 XX = .01 ANGLE = 30° 320A: 10S 10Y: FINISH |  | THIS PRINT IS CONFIDENTIAL AND IS THE PROPERTY OF DURST, DM, REGAL BELOFT CORP. THIS PRINT SHALL NOT BE USED, COPIED OR REPRODUCED IN WHOLE OR IN PART, NOR SHALL THE CONTENTS BE REVEALED IN ANY MANNER TO ANYONE UNLESS WRITTEN PERMISSION IS OBTAINED FROM DURST, DM, REGAL BELOFT CORP. |  | <br>DIVISION OF REGAL BELOFT CORP.<br>P.O. BOX 290<br>BELOFT, WISCONSIN 53511 |  |
| MATERIAL   |  | TITLE   |  | PART NO.  |  |
|  |  | 1PD06 INDEPENDENT CHARTED DRAWING   |  | 1PD06I  |  |
| SCALE 1:2  |  | THIRD ANGLE PROJECT   |  | SEE 0   |  |